

PARKING STALLS UNDER SHELTER

	EXIST.	ADJNL. SERD.	TOTAL
STREET & SANI. DIV.	2	22	24
ELECT. DIV.	1	1	2
BLDG. MAINT DEPT.	2	0	2
PARK DEPT.	1	9	10
GARBAGE DEPT.	14	4	18
WAREHOUSE DIV.	0	2	2
POLICE DEPT.	1	1	2
TOTALS	36	38	74

\* 2 Bays housed in existing shop

PARKING AREA

NEW DEVELOPMENT

DEPT	EL.	ULTIMATE
STREETS	2	30
ELECT.	1	2
BLDG. MAINT	2	2
PARKS	4	10
GARBAGE	14	27
WAREHOUSE	0	2
POLICE	3	6
TOTALS	36	79

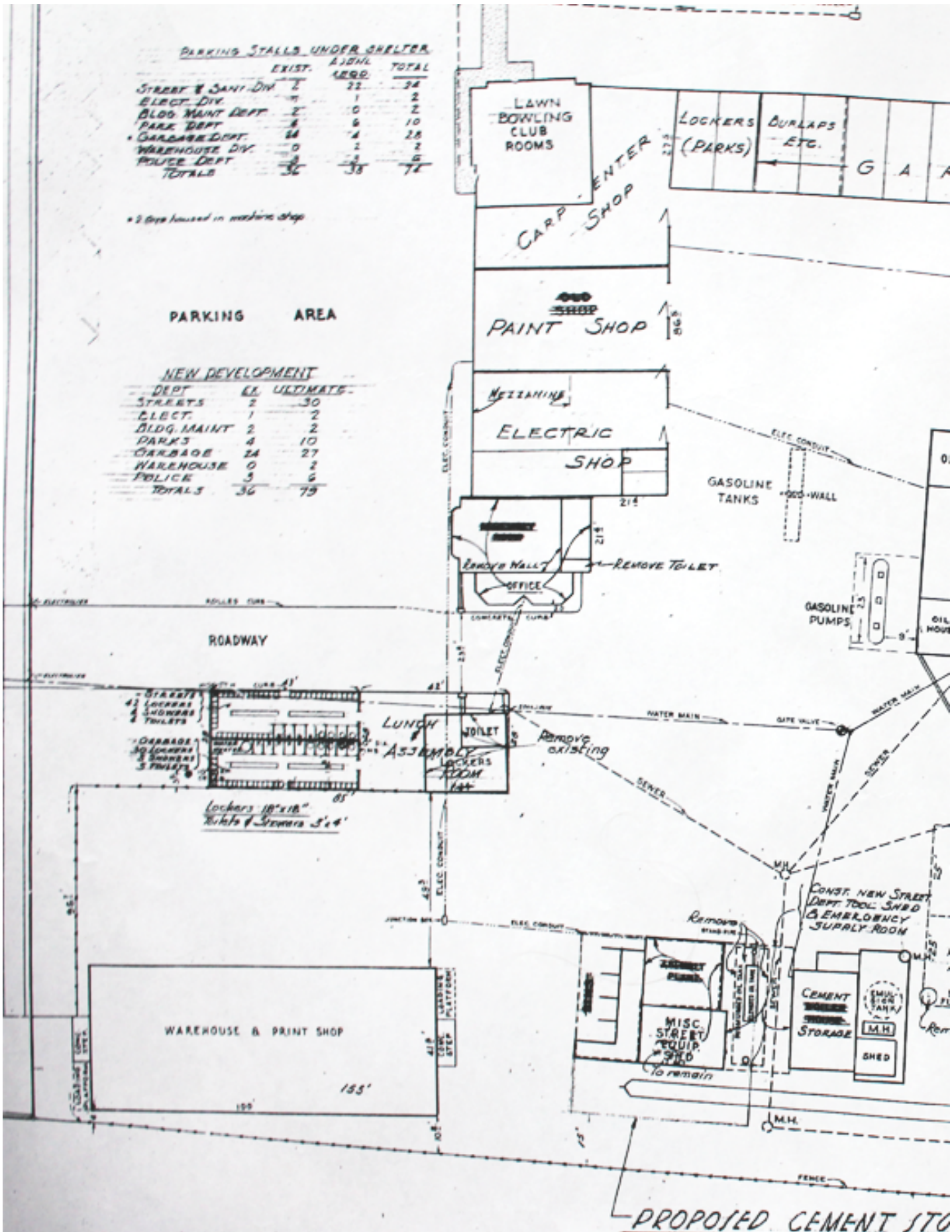

PLAN # 24937  
PH 43-17

CITY OF BERI